

***Ordering Note:** NYG82508 = Bronze w/ Graphite
 NYX82508 = Bronze w/ No Graphite
 NY82508X = Bronze w/ Grease Grooves

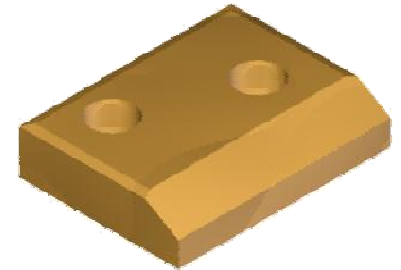
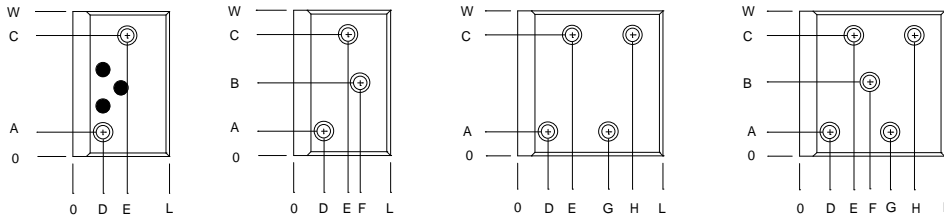

Materials: C959 Aluminum Bronze w/Graphite Plugs; 4140 Rc 56-62

Tolerances: Thickness: +/- .001; Flatness: +/- .0005; All Other: +/- .010

*Bronze w/Graphite	Plain Steel	Steel w/Graphite	W	L	Holes	A	B	C	D	E	F	G	H	
NYG82508	NSX82508	NSG82508	2.5	8.0	2	1.25		1.25	1.50	6.50				
NYG83025	NSX83025	NSG83025		2.5		.75		2.25	1.25	1.25				
NYG8303	NSX8303	NSG8303		3.0		.75		2.25	1.75	1.75				
NYG8304	NSX8304	NSG8304		4.0		.75		2.25	1.25	2.75				
NYG8305	NSX8305	NSG8305		5.0		.75		2.25	1.50	3.75				
NYG8306	NSX8306	NSG8306		6.0		.75		2.25	1.50	4.50				
NYG8308	NSX8308	NSG8308		8.0		.75		2.25	1.50	6.50				
NYG8310	NSX8310	NSG8310		10.0		.75	1.50	2.25	1.50	2.50	8.50			
NYG8312	NSX8312	NSG8312		12.0	.75	1.50	2.25	1.50	2.50	10.50				
NYG84025	NSX84025	NSG84025	4.0	2.5	2	1.25		2.75	1.25	1.25				
NYG8403	NSX8403	NSG8403				3.0	1.00		3.00	1.50	2.25			
NYG8404	NSX8404	NSG8404				4.0	1.00		3.00	1.25	2.75			
NYG8405	NSX8405	NSG8405				5.0	.88		3.12	1.50	3.75			
NYG8406	NSX8406	NSG8406			6.0	.88		3.12	1.50	4.50				
NYG8408	NSX8408	NSG8408			8.0	.88	2.00	3.12	1.50	2.50	6.50			
NYG8410	NSX8410	NSG8410			10.0	.88	2.00	3.12	1.50	2.50	8.50			
NYG8412	NSX8412	NSG8412			12.0	.88	2.00	3.12	1.50	2.50	10.50			
NYG85025	NSX85025	NSG85025	5.0	2.5	2	1.25		3.75	1.25	1.25				
NYG8504	NSX8504	NSG8504				4.0	1.00		4.00	1.50	2.75			
NYG8505	NSX8505	NSG8505				5.0	1.00		4.00	1.50	3.75			
NYG8506	NSX8506	NSG8506				6.0	1.00		4.00	1.50	4.50			
NYG8508	NSX8508	NSG8508			8.0	1.00	2.50	4.00	1.50	2.50	6.50			
NYG8510	NSX8510	NSG8510			10.0	1.00	2.50	4.00	1.50	2.50	8.50			
NYG8512	NSX8512	NSG8512			12.0	1.00		4.00	1.50	2.50		9.50	10.50	
NYG86025	NSX86025	NSG86025		6.0	2.5	2	1.50		4.50	1.25	1.25			
NYG8603	NSX8603	NSG8603			3.0	3	1.00	3.00	5.00	1.25	1.25	1.75		
NYG8604	NSX8604	NSG8604			4.0	3	1.00	3.00	5.00	1.25	2.25	2.75		
NYG8605	NSX8605	NSG8605			5.0	2	1.12		4.88	1.50	3.75			
NYG8606	NSX8606	NSG8606			6.0	4	1.00		5.00	1.25	2.25		3.75	4.75
NYG8608	NSX8608	NSG8608			8.0	4	1.00		5.00	1.25	2.25		5.75	6.75
NYG8610	NSX8610	NSG8610			10.0	5	1.00	3.00	5.00	1.25	2.25	5.00	7.75	8.75
NYG8612	NSX8612	NSG8612			12.0	5	1.00	3.00	5.00	1.25	2.25	6.00	9.75	10.75
NYG88025	NSX88025	NSG88025	8.0	2.5	2	1.50		6.50	1.25	1.25				
NYG8805	NSX8805	NSG8805				5.0	1.25		6.75	1.50	3.75			
NYG8806	NSX8806	NSG8806			6.0	4	1.00		7.00	1.25	2.25		3.75	4.75
NYG810025	NSX810025	NSG810025			10.0	2	1.75		8.25	1.25	1.25			